

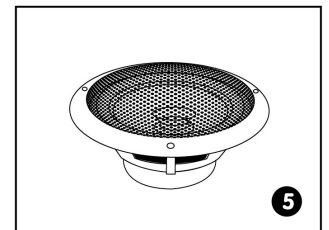

# OWNER'S MANUAL

## MODEL: **L4606070**

6.5" Dual Full Range Speaker  
Completely Waterproof  
For Marine or Car use  
Polypropylene Cone with Rubber Edge  
Molded ABS Plastic Basket  
Max Power: 120 Watts  
Magnet: 8 Oz  
Frequency Response: 60Hz-18KHz  
Impedance: 4 Ohms  
Sensitivity: 91 dB  
Dimensions: D180, d135, H85, h63

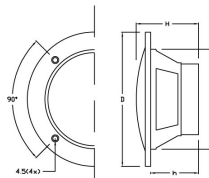

Complete.

### INSTALLATION GUIDE

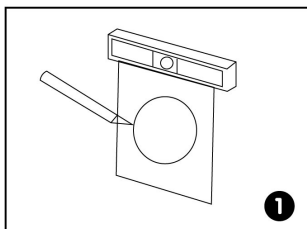

Cut the drywall.  
Note: Always allow at least one-half inch between a wall stud and the speaker cutout or the locking tabs will not be able to swivel into place.

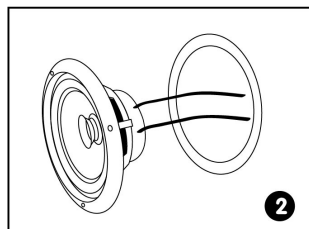

Connect the speaker wires to the speaker.

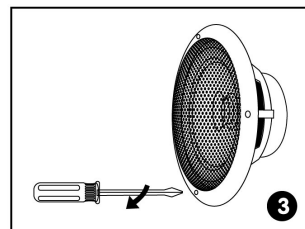

Screw down each of the four Phillips head screws. The locking tabs will swivel into place and secure the unit to the rear surface of the drywall. Put in the strips of adhesive to secure the grille.

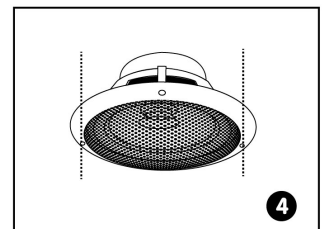

Replace the metal grille.

L4606070(DBS6003W)/297\*210mm/80克双铜/单色